

ONYX

TECHNOLOGY POWERING A CLEANER FUTURE

LX600

17HP 603cc PROPANE ENGINE

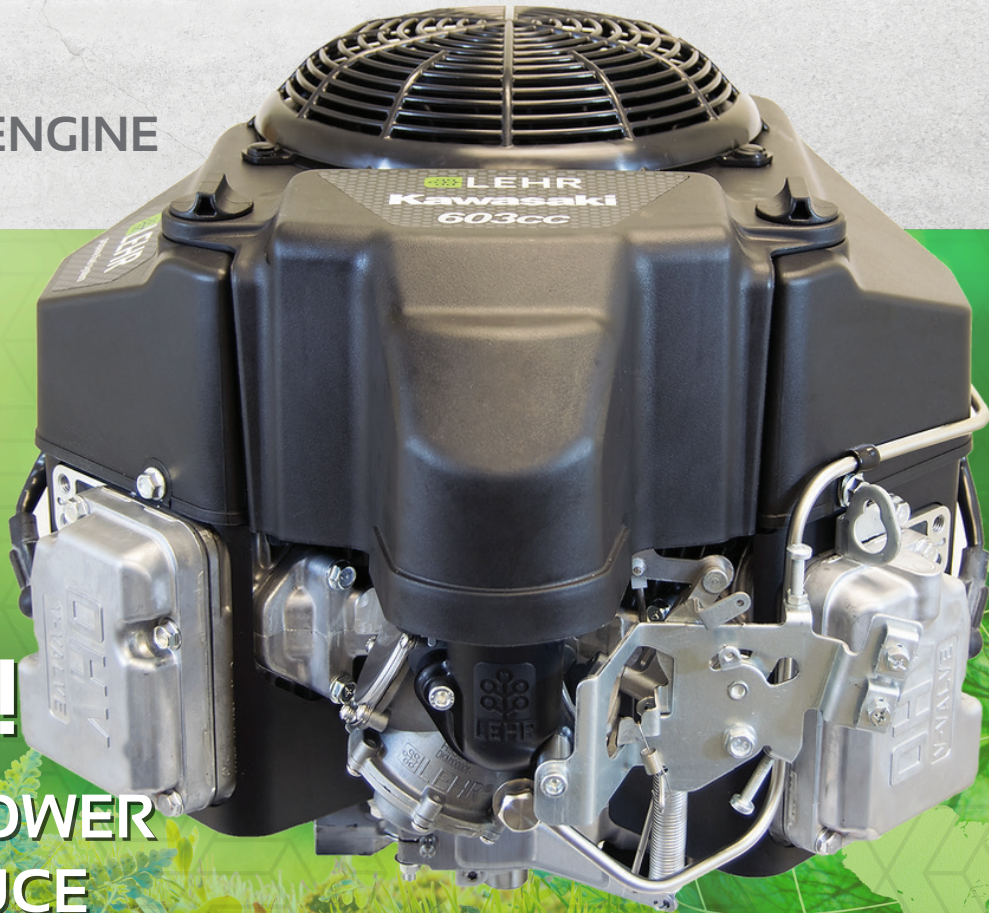

GO GREEN!

WE HELP OEM'S LOWER
EMMISSIONS, REDUCE
MAINTENANCE, &
LOWER FUEL COSTS

ONYX engines are powered by clean burning propane gas and achieve ultra low emissions without sacrificing power or performance. Each engine carries a full manufacturers warranty and is individually dyno tested to ensure performance and emissions meet our Environmental Protection Agency and the California Air Resources Board certifications. ONYX propane engines are available with all necessary components to convert a gasoline application to operate on propane.

ONYX ENGINES FEATURE:

- Cleanest Emissions In Class
- 9 to 35hp Vertical & Horizontal Shaft
- Full 3 Year Manufacturers Warranty
- EPA & CARB Certified
- Product Design Support
- SAM Carbon Monoxide Shutdown (optional)

LX600 17HP PROPANE ENGINE

ONYX LX600 engines operate on clean burning propane fuel significantly reducing emissions while increasing safety and reliability.

CLEANEST EMISSIONS IN CLASS

LEHR Propane Fuel Systems on the LX600 are certified 53% cleaner emissions than the closest engine in its class according to the Environmental Protection Agency. Standard low tone catalytic mufflers reduce carbon monoxide emissions well below OSHA permissible exposure limits. SAM Safe Air Monitor further increases safety by alerting operators should carbon monoxide levels climb to unsafe levels and will automatically shut engines down to prevent injury.

RELIABILITY

LEHR Propane Fuel Systems use a patented variable venturi and fuel jet design which never comes out of calibration and requires no field adjustments. LEHR systems utilize a threestage pressure regulator that vaporizes any liquid propane caused by overfilled cylinders or use of liquid cylinders making the LX600 the safest and most reliable engine in its class.

DESIGNED FOR PROPANE DURABILITY

Heavy-duty piston rings, a cast iron cylinder liner, and hardened heads designed for propane fuel resist wear and ensure precise timing for long engine life in commercial and industrial applications. Our heavy duty, low tone catalytic muffler is supported back to the engine block with two brackets and lasts the life of the engine.

SPECIFICATIONS

Type:	Air-cooled, V-Twin OHV
Power:	17hp (12.7 kW)
Size:	603cc Vertical Shaft
Bore x Stroke:	73mm x 72mm
Fuel System:	LEHR Variable Venturi
Fuel Type:	Vapor Propane
Starter:	Electric 12v
Oil Capacity:	2 Liters
Dry Weight:	81lbs.
Air Cleaner:	Dual Element
Muffler:	Low Tone Catalytic
Cylinder:	V-Twin, Hardened
Crankshaft:	1" Keyed PTO

POWER CURVE

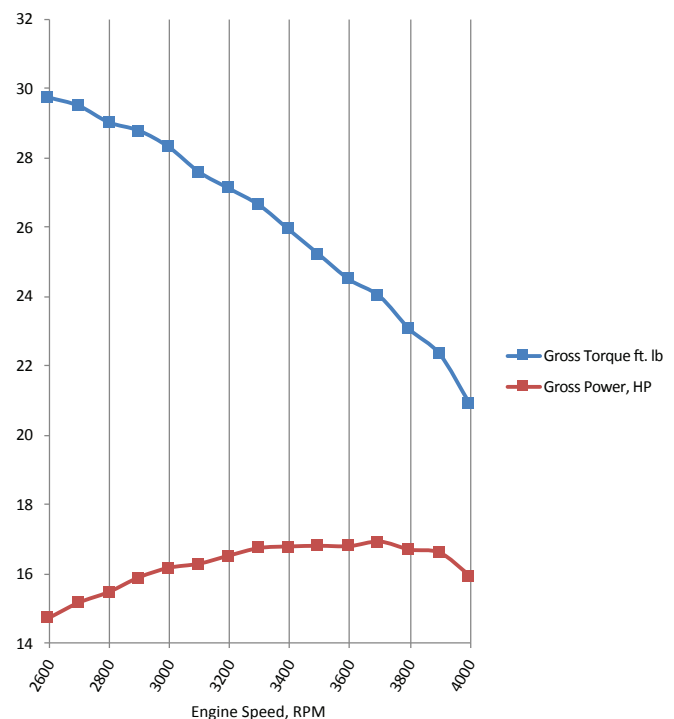

ONYX has a long-standing commitment to providing the highest quality products and the best customer service in the industry. All of our products are designed and manufactured in the U.S., have a full warranty, and carry a full EPA & CARB Certification. Our network of over 1000 trained dealers are ready to provide service and repair for any product.

LX600 17HP PROPANE ENGINE

DIMENSIONS

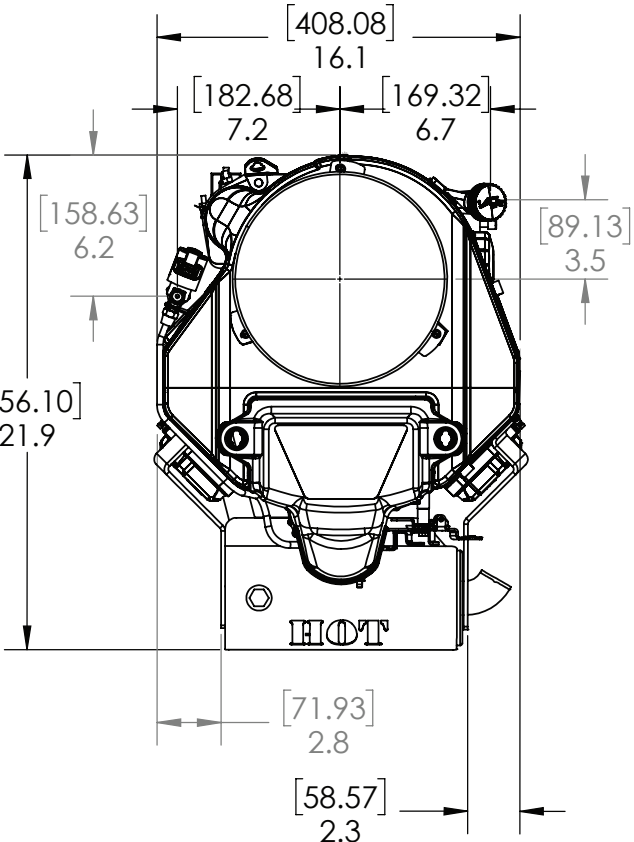
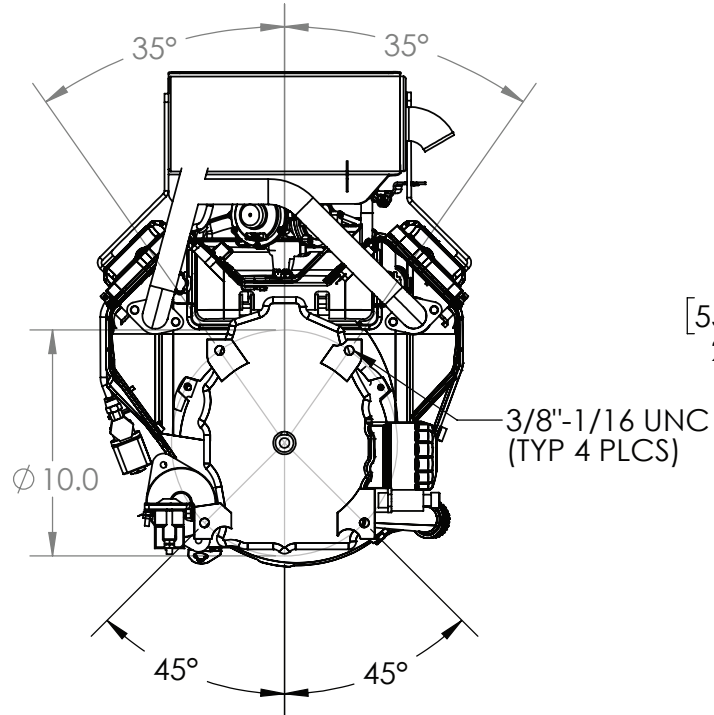
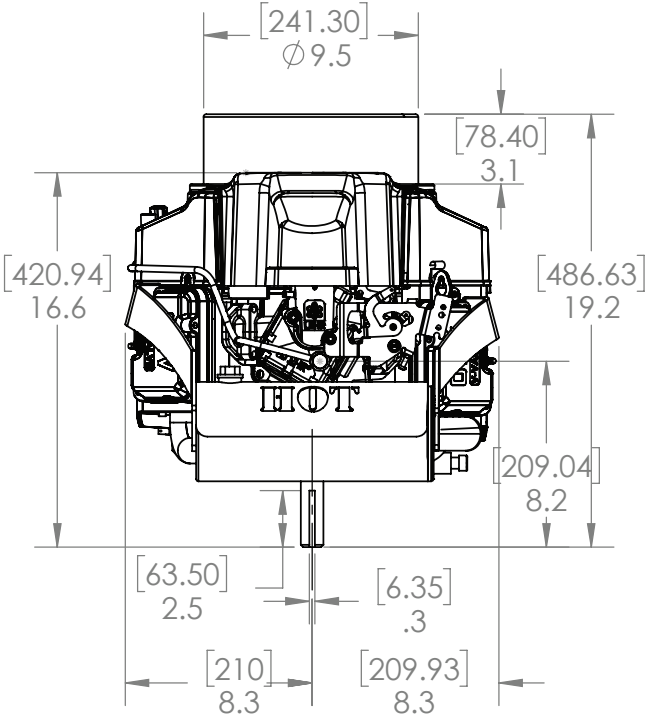
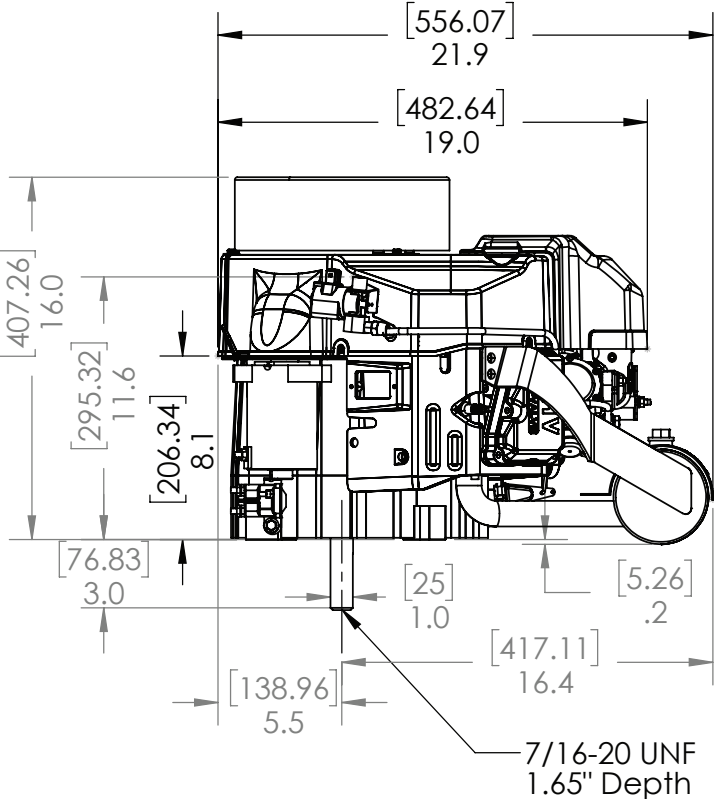



12703 Commerce Station Dr • Suite 200
Huntersville, NC 28078
704.827.9368



onyxsolutions.com